

EXTERNAL ELEVATIONS

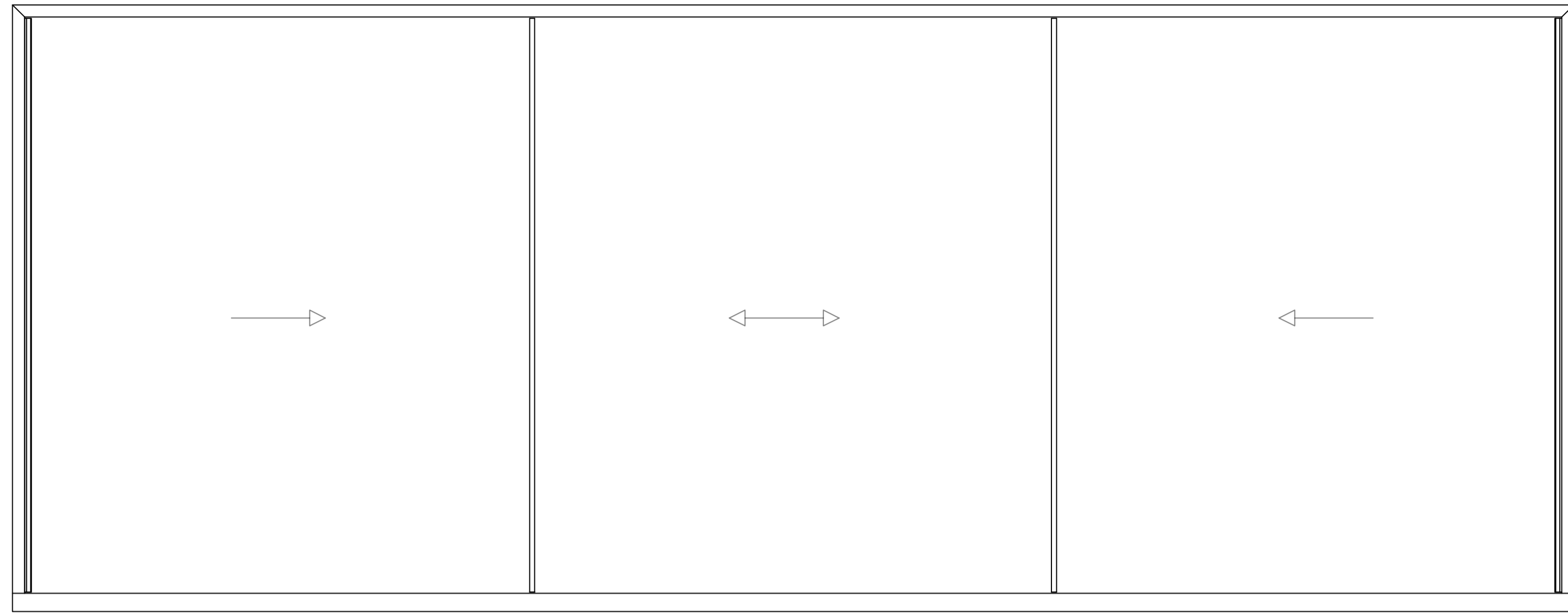

EXTERNAL ELEVATION  
1:16 @ A1

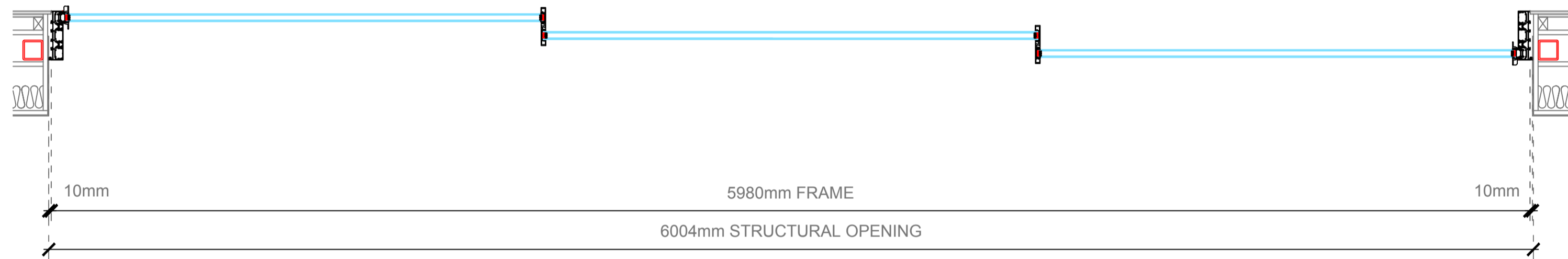

PLAN VIEW  
1:16 @ A1

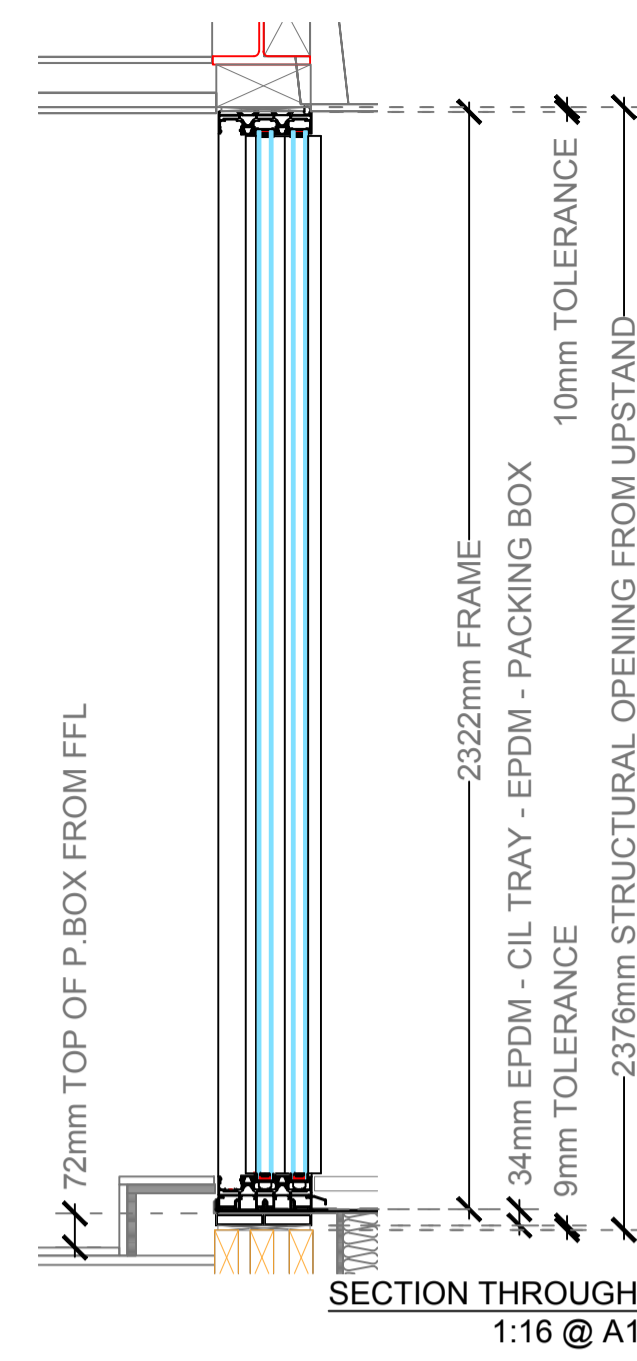

SECTION THROUGH  
1:16 @ A1

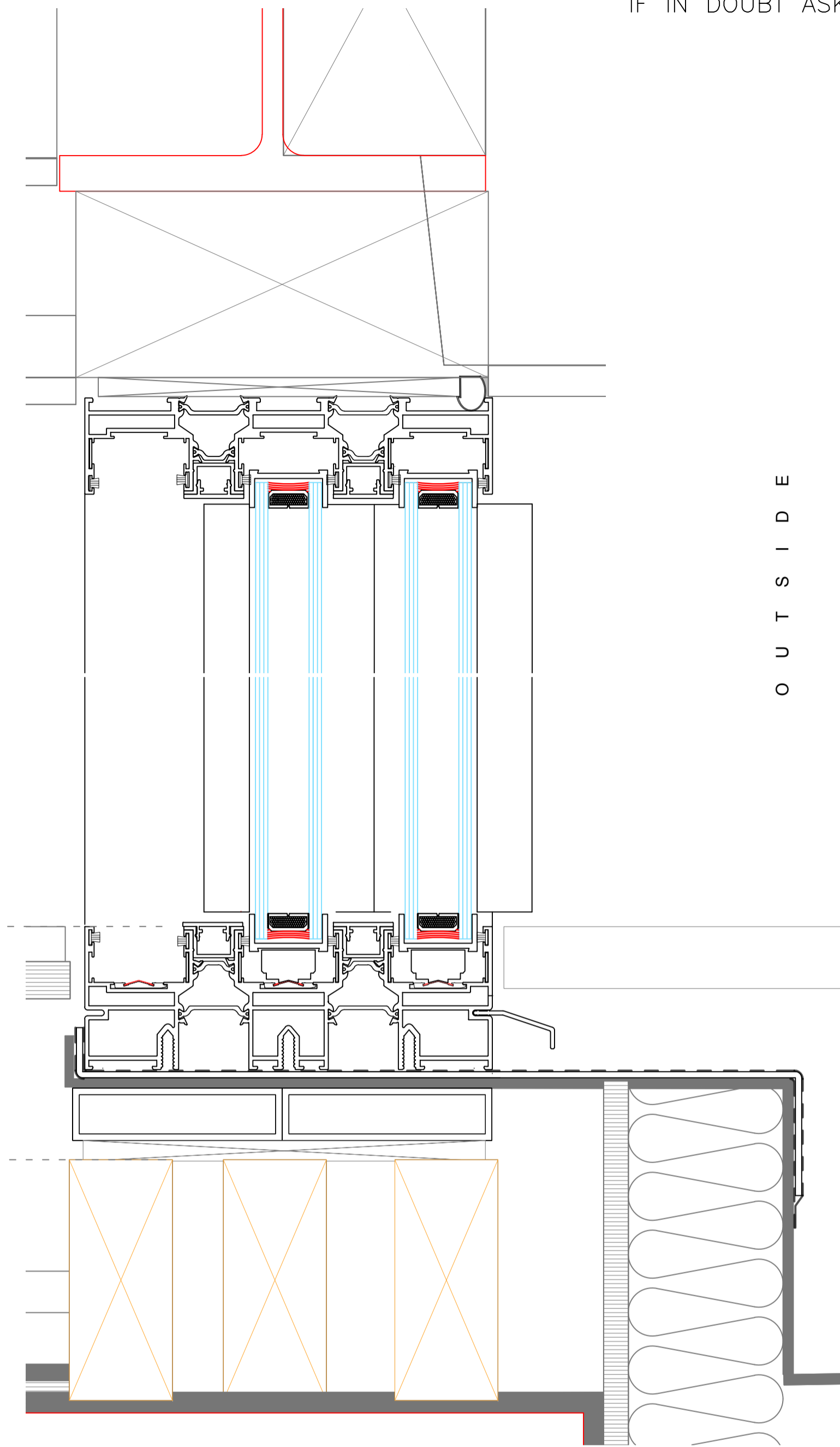

IF IN DOUBT ASK

O U T S I D E

SPECIFICATION

MATERIAL	SUNVISTA
FINISH	POLYESTER POWDER COATED RAL: 7012 MATT
GLASS	32MM 6MM CLAEER TOUGH - EXT 20MM BLACK ARGON CAVITY 6MM CLEAR LOW-E TOUGH - INT
GLAZING	BLACK GASKET
FIXING	BY NORTHOLT GLASS
POINTING	SILICONE
GEARING	

FITTINGS

**ISSUE FOR CONSTRUCTION**  
08.07.2019

C		
B	HALE.B note incl - CONSTRUCTION	08.07.2019
A	Revised as per latest details by HALE.B	02.07.2019

AMENDMENTS

SITE	
Blades Court 121 Deodor Road Putney London SW15 2NU	
ARCHITECT	
CONTRACTOR	
TITLE	
FLAT 11 SLIDING DOOR SET	

DRAWN	DATE	SCALE
RAH	14.05.2019	1:16/2 @ A1

**NG** ARCHITECTURAL  
GLASS & ALUMINIUM SYSTEMS  
UNIT 2, CHILTERN BUSINESS VILLAGE, ARUNDEL ROAD  
UXBRIDGE, MIDDLESEX, UB8 2SN  
E-mail: info@northoltglass.co.uk  
TEL: 01895 206650 FAX: 01895 238471

DRG.No. **19 2390 .05 B**

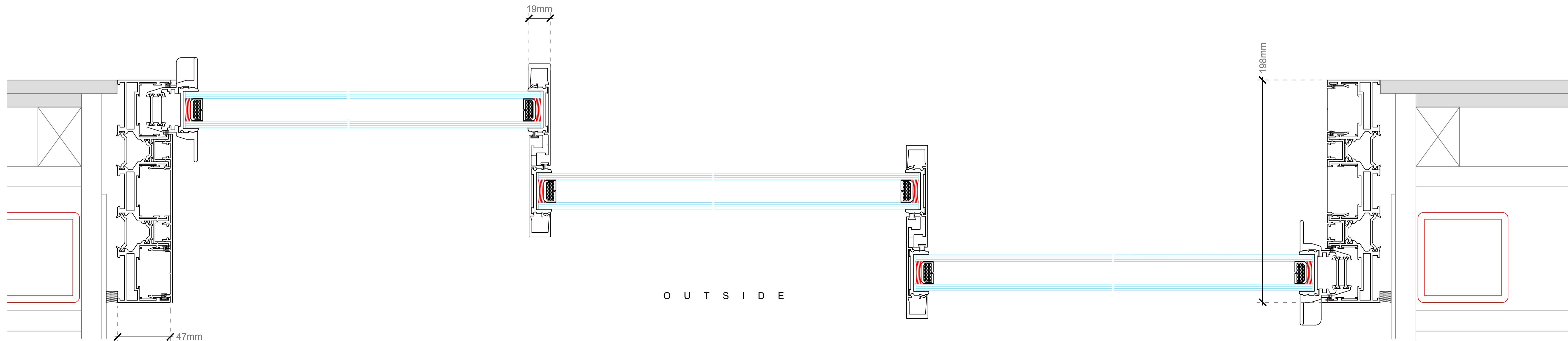

O U T S I D E